



Rewarding Learning

General Certificate of Secondary Education
2013

Centre Number

--	--	--	--	--

Candidate Number

--	--	--	--

French

Unit 4: Reading

Foundation Tier



[GFR41]

GFR41

THURSDAY 13 JUNE, MORNING

TIME

40 minutes.

INSTRUCTIONS TO CANDIDATES

Write your Centre Number and Candidate Number in the spaces provided at the top of this page.

Write your answers in the spaces provided in this question paper.

Complete in blue or black ink only. **Do not write in pencil or with a gel pen.**

Answer **all thirteen** questions.

INFORMATION FOR CANDIDATES

The total mark for this paper is 40.

Figures in brackets printed down the right-hand side of pages indicate the marks awarded to each question or part question.

Use of a dictionary is **not** permitted.



3 Read these directions in a French town.

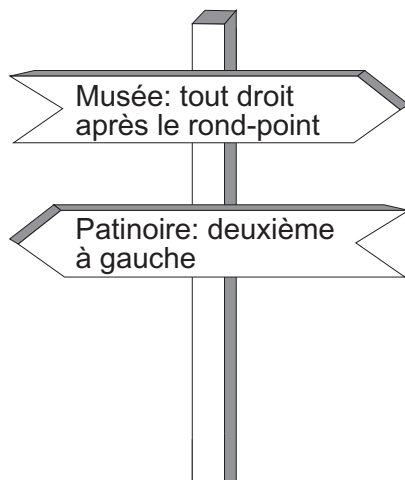

Choose the correct map for:

(a) the museum

(b) the skating rink

[2]

Write the **two** correct letters in the boxes.

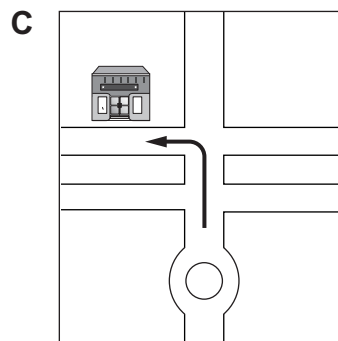
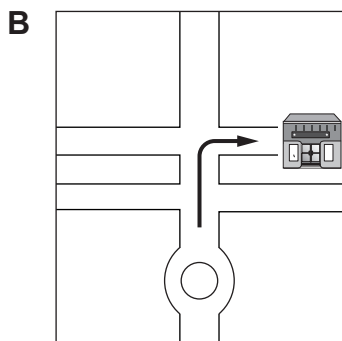
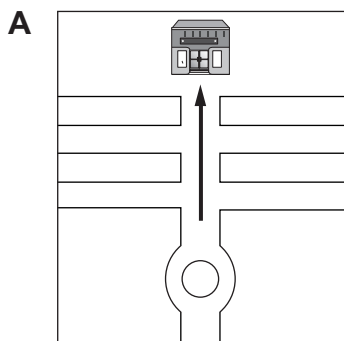

Examiner Only	
Marks	Remark
Total Question 3	



4 Read Claudine's diary.

lundi faire les devoirs	vendredi aller à la disco
mardi aller au cinéma	samedi faire les courses
mercredi jouer au basket	dimanche faire du vélo
jeudi faire les devoirs	petites notes *acheter un cadeau d'anniversaire pour maman!

Answer the questions in **English**.

(a) What will Claudine do on Monday and Thursday evenings?

_____ [1]

(b) What does she plan for Saturday?

_____ [1]

(c) What must she remember to buy for her mother?

_____ [1]

Examiner Only

Marks Remark

Total Question 4

[Turn over



7 Regarde le Menu du Jour.

MENU à 15 €



- A Assiette de charcuterie
ou
- B Assiette de crudités
ou
- C Terrine de saumon
- D Saucisse
ou
- E Côte de porc
ou
- F Crêpe au fromage

Paul déteste le poisson et la viande. Qu'est-ce qu'il va choisir?

Ecris les **deux** bonnes lettres.

_____ et _____ .

[2]

Examiner Only

Marks

Remark

Total Question 7



8 Relie les Règlements de la piscine et les images.

Ecris les **trois** bonnes lettres dans les cases.

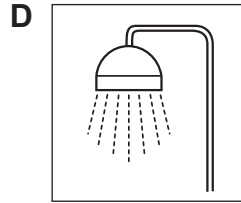
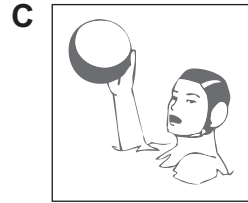
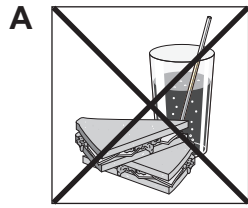

(a) Se doucher avant de se baigner

(b) Maillot de bain obligatoire

(c) Alimentation interdite

[3]

Examiner Only

Marks Remark

Total Question 8

[Turn over



10 Regarde la Météo pour une région en France.

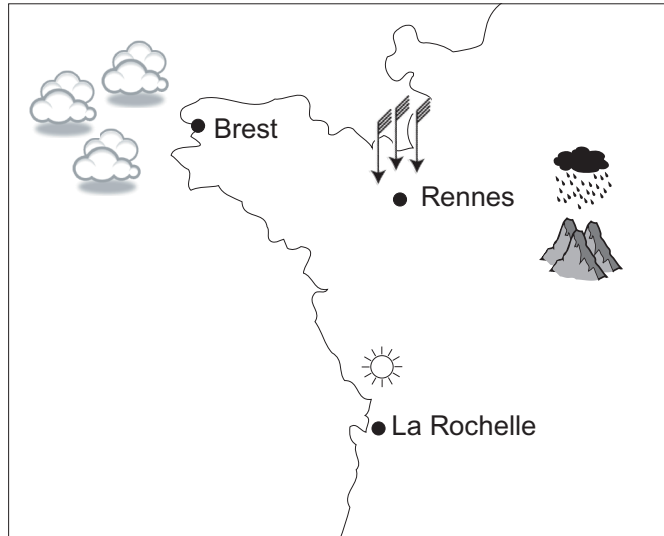

Complète les phrases.

Ecris les **quatre** bonnes lettres.

- (a) A La Rochelle . . .
- (b) Près de Rennes . . .
- (c) A la montagne . . .
- (d) Dans le nord-ouest . . .

[4]

- A . . . il pleut.
- B . . . il est nuageux.
- C . . . il neige.
- D . . . le soleil brille.
- E . . . il y a des vents forts.

Examiner Only

Marks Remark

Total Question 10

[Turn over





DO NOT WRITE ON THIS PAGE
(Questions continue overleaf)

8060

[Turn over



20GFR4113



THIS IS THE END OF THE QUESTION PAPER

8060



20GFR4117

DO NOT WRITE ON THIS PAGE

8060



20GFR4118



DO NOT WRITE ON THIS PAGE

8060



20GFR4119

DO NOT WRITE ON THIS PAGE

For Examiner's use only	
Question Number	Marks
1	
2	
3	
4	
5	
6	
7	
8	
9	
10	
11	
12	
13	

Total Marks	
--------------------	--

Examiner Number

Permission to reproduce all copyright material has been applied for.
In some cases, efforts to contact copyright holders may have been unsuccessful and CCEA will be happy to rectify any omissions of acknowledgement in future if notified.

8060/7



20GFR4120