

**OXFORD CAMBRIDGE AND RSA EXAMINATIONS
GCSE**

A914/02

**HEALTH AND SOCIAL CARE
Safeguarding and Protecting
Individuals**

**Monday 15 June 2015:
Afternoon**

**DURATION: 1 hour
plus your additional time allowance
MODIFIED ENLARGED 24pt**

Candidate forename						Candidate surname				
Centre number						Candidate number				

Candidates answer on the Question Paper.

OCR SUPPLIED MATERIALS:

None

OTHER MATERIALS REQUIRED:

None

READ INSTRUCTIONS OVERLEAF

INSTRUCTIONS TO CANDIDATES

Write your name, centre number and candidate number in the boxes on the first page. Please write clearly and in capital letters.

Use black ink. Pencil may be used for graphs and diagrams only.

Read each question carefully. Make sure you know what you have to do before starting your answer.

Write your answer to each question in the space provided. If additional space is required, you should use the lined pages at the end of this booklet. The question number(s) must be clearly shown.

Answer ALL the questions.

INFORMATION FOR CANDIDATES

The number of marks is given in brackets [] at the end of each question or part question.

Quality of Written Communication will be assessed in questions marked with an asterisk (*).

The total number of marks for this paper is 60.

Answer ALL the questions.

1 Select THREE situations, from the following, where individuals may need to be safeguarded.

Situations	Tick (✓) the three situations
Being regularly shouted at.	
Being expected to do the washing up.	
Not being allowed to watch your choice of TV programme.	
Being slapped.	
Theft of personal property.	

[3]

[illegible]

[6]

3 State ONE piece of legislation which contributes to safeguarding people with learning difficulties.

Describe THREE key features of this legislation.

[7]

- 4

State TWO different situations when care staff should wash their hands.

1.

2.

[2]
- 5

Describe THREE ways hazardous waste should be disposed of in a nursing home.

1.

2.

3.

[6]

6 Describe the purpose of food safety legislation.

[2]

7 Describe the purpose of immunisation.

[2]

8* Jayne is a first aider. She gives treatment to a child who has a scald to her hand from hot water.

Explain the first aid procedure Jayne should give for a scald.

[illegible]

9 Give TWO different examples of health emergencies which may cause breathing difficulties.

1. _____

2. _____ [2]

10* You need to call the emergency services for an individual who has breathing difficulties.

Explain the importance of information that you need to give to the emergency services.

[illegible]

11 State the purpose of each of the following safety signs used in a hospital.

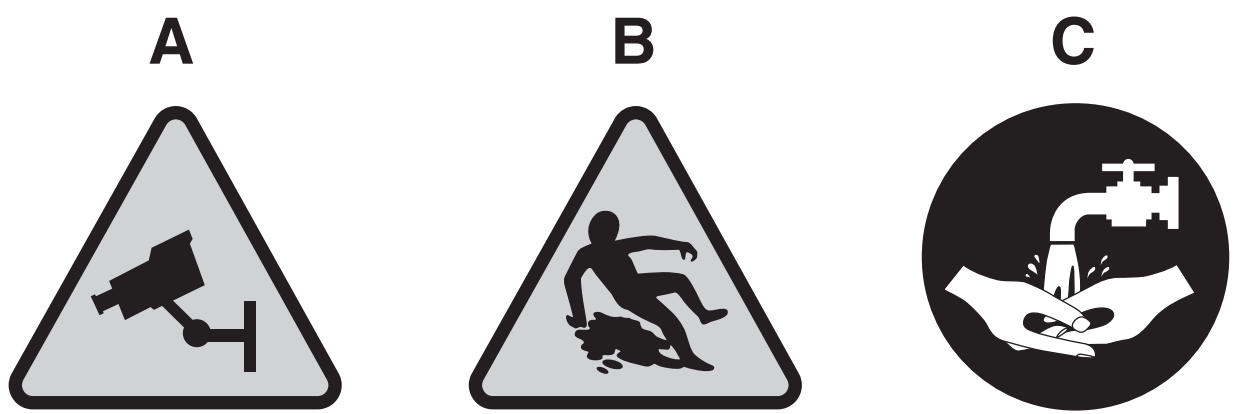

A

B

C

[3]

12* Explain the importance of keeping written records of a risk assessment.

[illegible]

Key

- 

First Aid Box
- 

Door
- 

Fire Blanket
- 

Fire Extinguisher
- 

FER Fire Escape Ramp
- 

Extension lead
- 

Electric Socket

Plan of Play Group

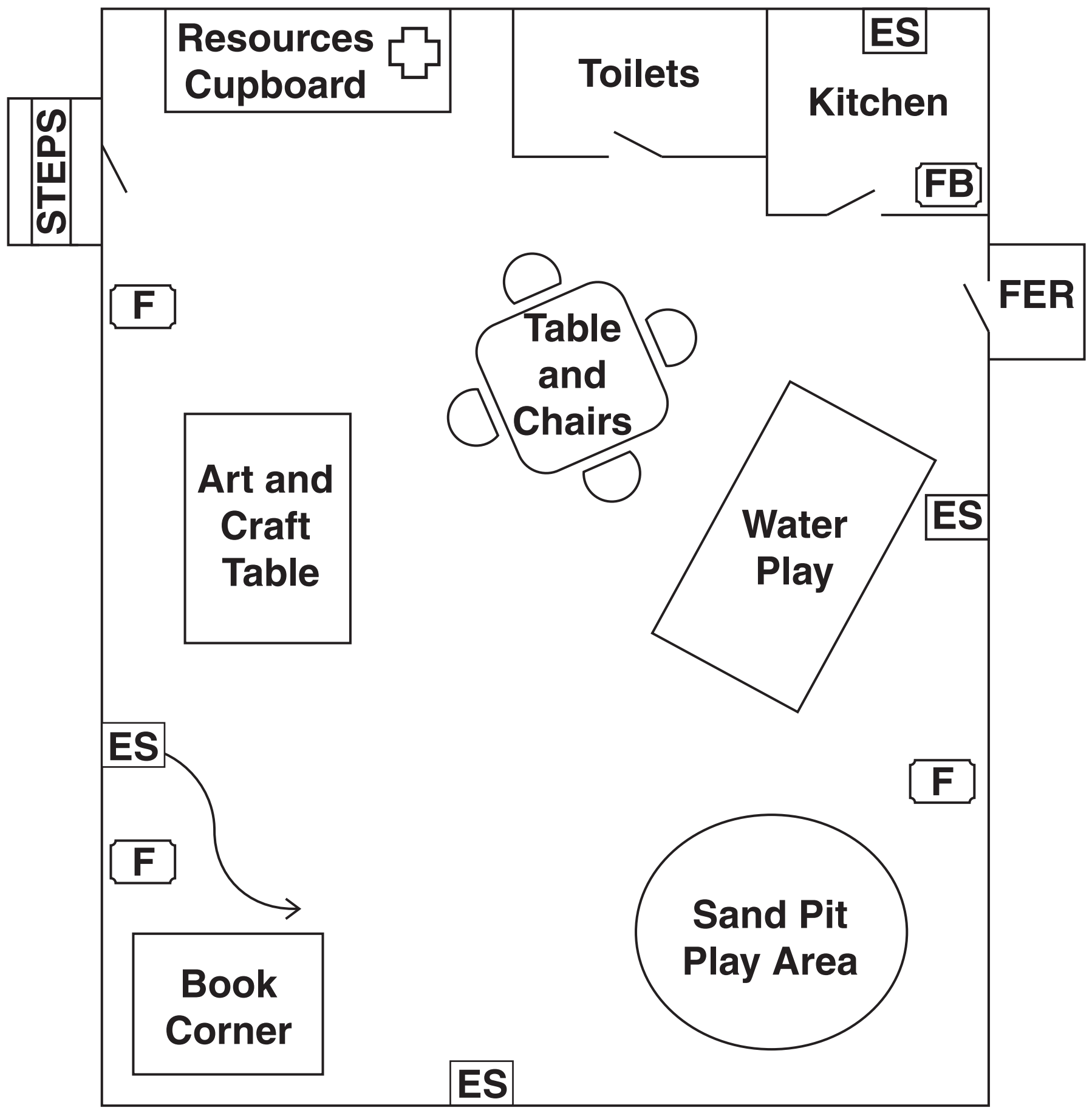

13* Carry out a risk assessment for the play group. You need to:

look for hazards

think about who may be harmed

consider the risks – whether precautions are adequate [8]

[illegible]

END OF QUESTION PAPER

ADDITIONAL ANSWER SPACE

If additional answer space is required, you should use the following lined page(s). The question number(s) must be clearly shown.

[illegible]

Copyright Information

OCR is committed to seeking permission to reproduce all third-party content that it uses in its assessment materials. OCR has attempted to identify and contact all copyright holders whose work is used in this paper. To avoid the issue of disclosure of answer-related information to candidates, all copyright acknowledgements are reproduced in the OCR Copyright Acknowledgements Booklet. This is produced for each series of examinations and is freely available to download from our public website (www.ocr.org.uk) after the live examination series.

If OCR has unwittingly failed to correctly acknowledge or clear any third-party content in this assessment material, OCR will be happy to correct its mistake at the earliest possible opportunity.

For queries or further information please contact the Copyright Team, First Floor, 9 Hills Road, Cambridge CB2 1GE.

OCR is part of the Cambridge Assessment Group; Cambridge Assessment is the brand name of University of Cambridge Local Examinations Syndicate (UCLES), which is itself a department of the University of Cambridge.

